

ONDERVLOER VOOR PVC/SPC CLICK EN STICK VLOEREN ROL 9M²

UNDERLAY FOR PVC/SPC CLICK AND STICK FLOORS 9M²

NL

Professionele ondervloer voor pvc/spc click vloeren. Ook geschikt voor zelfklevende pvc vloeren.



GB

Professional subfloor for pvc/spc flooring with click system. Also suitable for stick/self-adhesive vinyl floors.

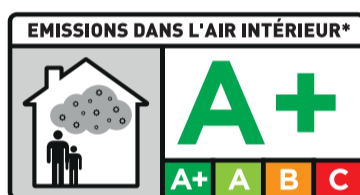
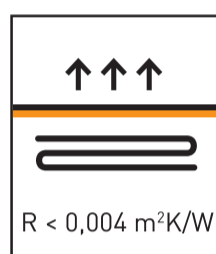
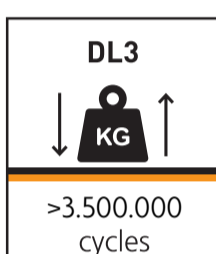
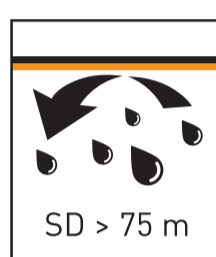
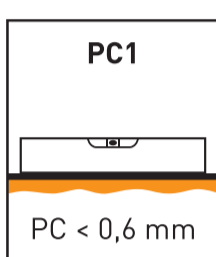
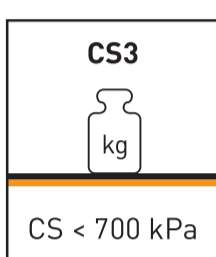
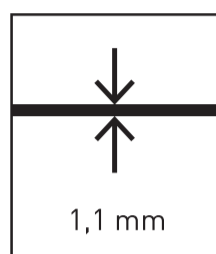
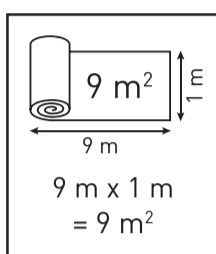

*Information sur le niveau d'émission de substances volatiles dans l'air intérieur, présentant un risque de toxicité par inhalation, sur une échelle de classe allant de A+ (très faibles émissions) à C (fortes émissions)

MONTAGE/INSTALLATION

**VOLG ALTIJD DE INSTRUCTIES VAN DE FABRIKANT!
ALWAYS FOLLOW THE MANUFACTURER'S INSTRUCTION!**

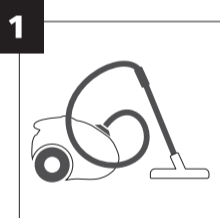

De ondervloer moet egaal, schoon, hard en droog zijn.

The base floor must be flat, clean, hard and dry.

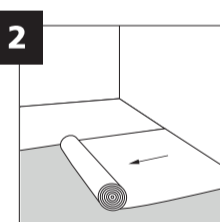

Rol de ondervloer uit op een droge betonvloer. De Aquastop laag (de glimmende zijde) moet naar boven liggen.

Unroll the underlay on a clean and dry concrete floor. The Aquastop layer (the shiny side) should be facing up.

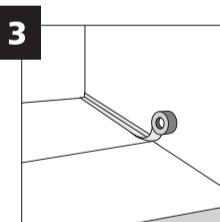

Plak de ondervloer tegen de muur met ALU tape om volledige hydro isolatie te krijgen. ALU tape is verkrijgbaar als een accessoire.

To provide fully hydro insulation stick the underlay to the wall using ALU tape. ALU tape is available as an accessory.

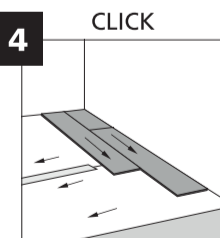

CLICK

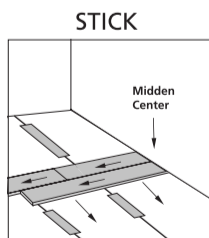

STICK

Plaats de vloer loodrecht op de ondervloer, volg de instructies die bijgeleverd is door de fabrikant.

Place the floor perpendicular to the underlay, follow the instructions provided by the manufacturer



P.O. Box 770
1000 AT Amsterdam
fetimgroup.com

Art.nr. 1208750



8 718848 204246